

# M Metal Mart

## 24' x 24' QUICKPORT

Drawings are not to scale

### MATERIAL LIST

2 ea - 4" x 14 Ga x 24' Square Tubing  
*cut in half*

6 ea - 8" 14 Ga x 25' Cee Purlin  
*cut to 24'-0"*

2 ea - 8-3/16" x 25' Primed Cee Channel  
*cut to 23'-6"*

8 ea - 26 Gauge x 24' Sheeting

200 ea - #12 x 3/4" S.D. Screws (sheeting)

100 ea - #12-14 x 1" S.D. Screws (framing)

100 ea - #14 x 7/8" Lap Screws (sheet laps)

**Ask about trim options!**

**NOTE:** This structure has no engineered specifications but has produced excellent results in numerous installations. Please check local building codes for compliance.

# M Metal Mart

## 24' x 24' QUICKPORT

Drawings are not to scale

### STEP 1

Ⓐ will equal Ⓑ when square.

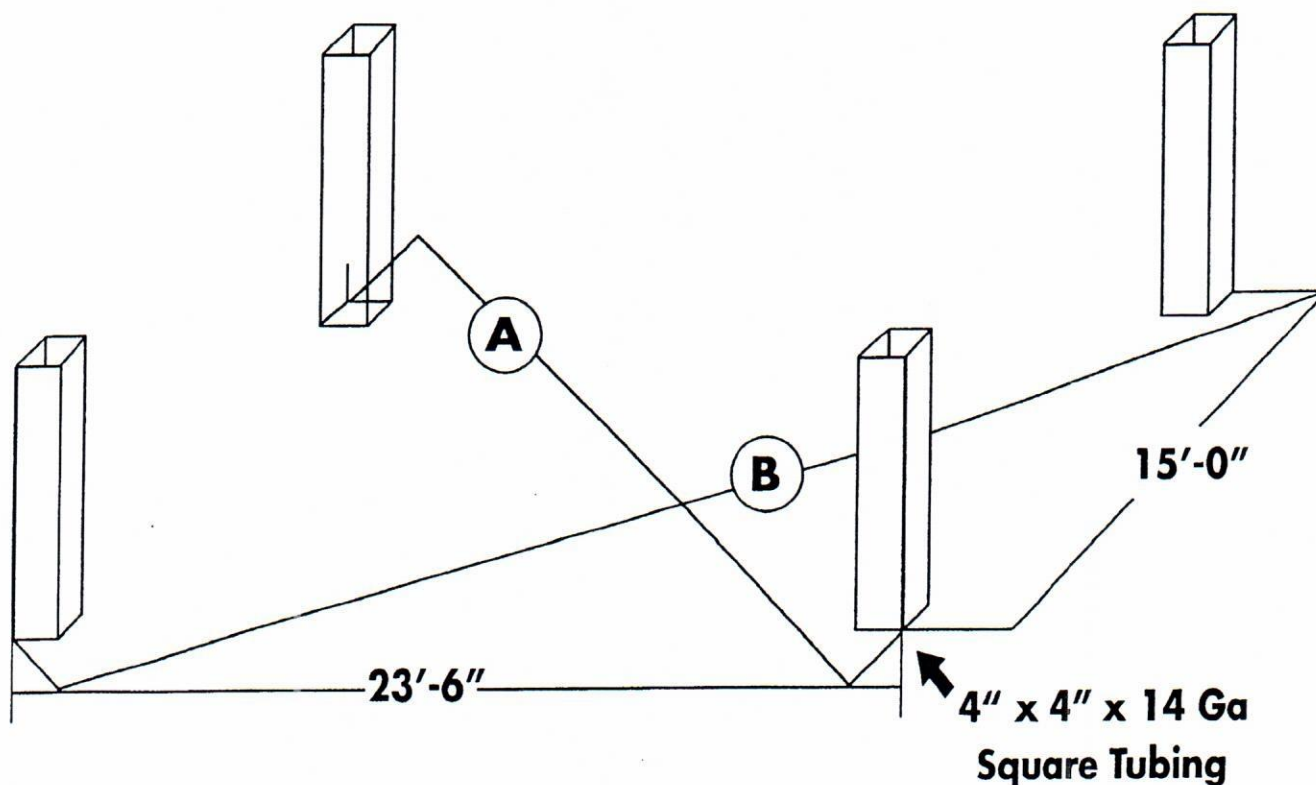

**NOTE:** This structure has no engineered specifications but has produced excellent results in numerous installations. Please check local building codes for compliance.

# M Metal Mart

## 24' x 24' QUICKPORT

Drawings are not to scale

### STEP 2

8" x 2-1/2" x 14 Ga  
Primed Cee Purlin

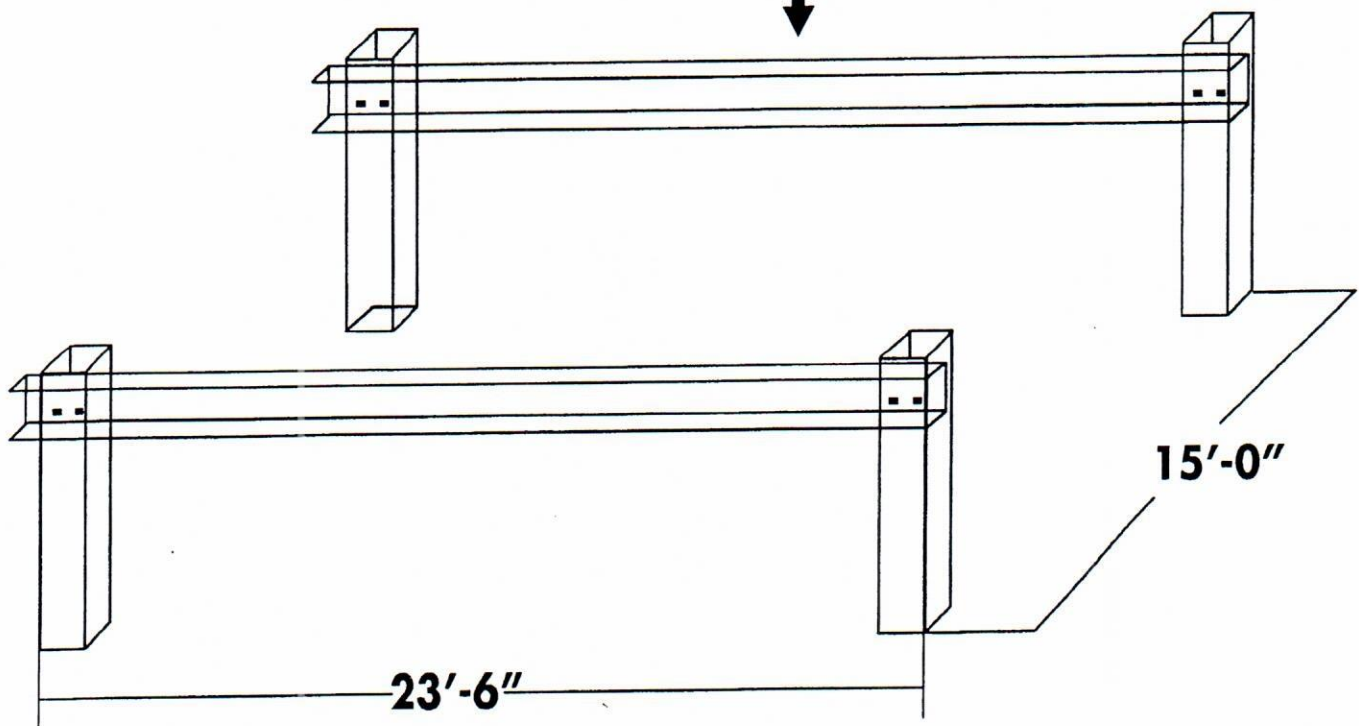

**NOTE:** This structure has no engineered specifications but has produced excellent results in numerous installations. Please check local building codes for compliance.



# M Metal Mart

## 24' x 24' QUICKPORT

Drawings are not to scale

### STEP 3

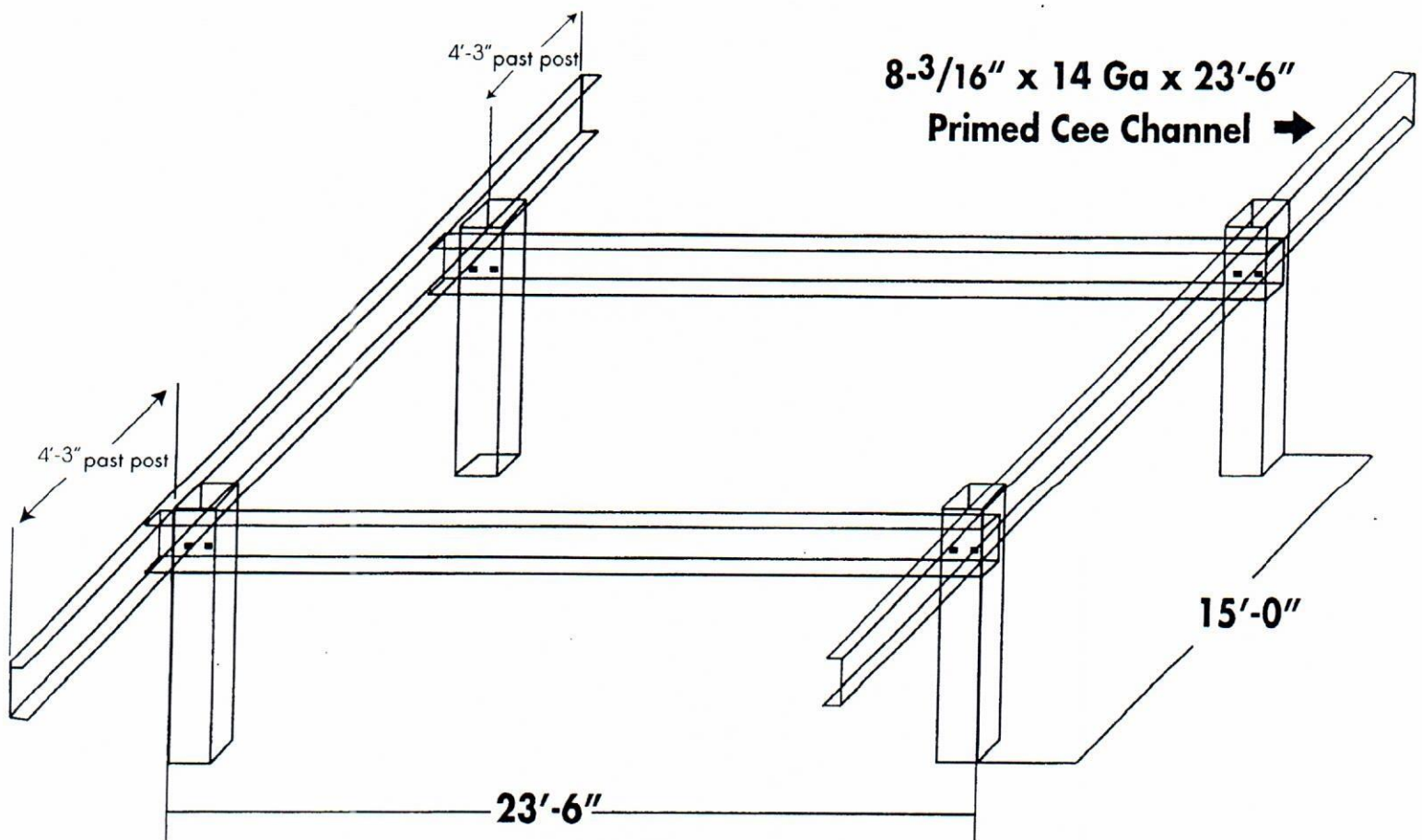

**NOTE:** This structure has no engineered specifications but has produced excellent results in numerous installations. Please check local building codes for compliance.

# M Metal Mart

## 24' x 24' QUICKPORT

Drawings are not to scale

### STEP 4

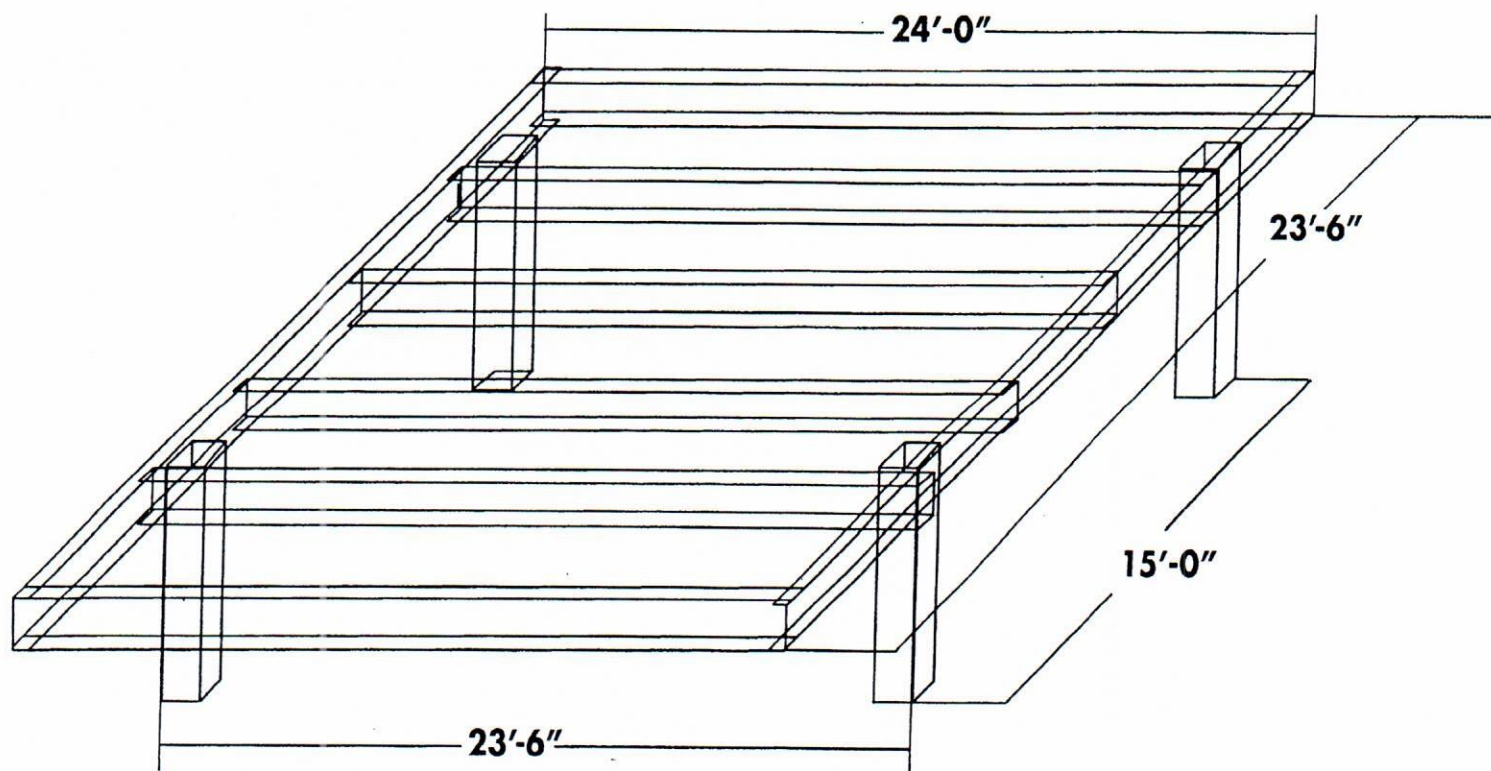

**NOTE:** This structure has no engineered specifications but has produced excellent results in numerous installations. Please check local building codes for compliance.

# M Metal Mart

## 24' x 24' QUICKPORT

Drawings are not to scale

### STEP 5

### SHEET APPLICATION

AFTER STRUCTURE HAS BEEN PAINTED SEE DETAIL **A**

Each roof sheet covers 3';  
therefore, 8 sheets cover 24'

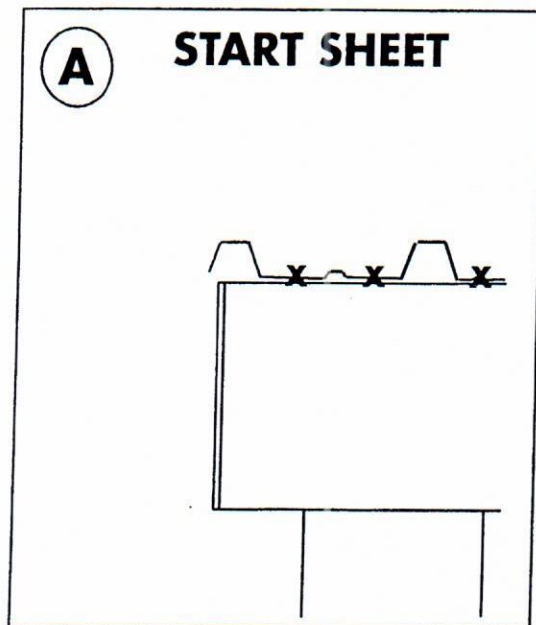

- - MARKS LAP SCREW
- X - MARKS S.D. SCREW
- #12 X 3/4" S.D. and
- #14 X 7/8" LAP

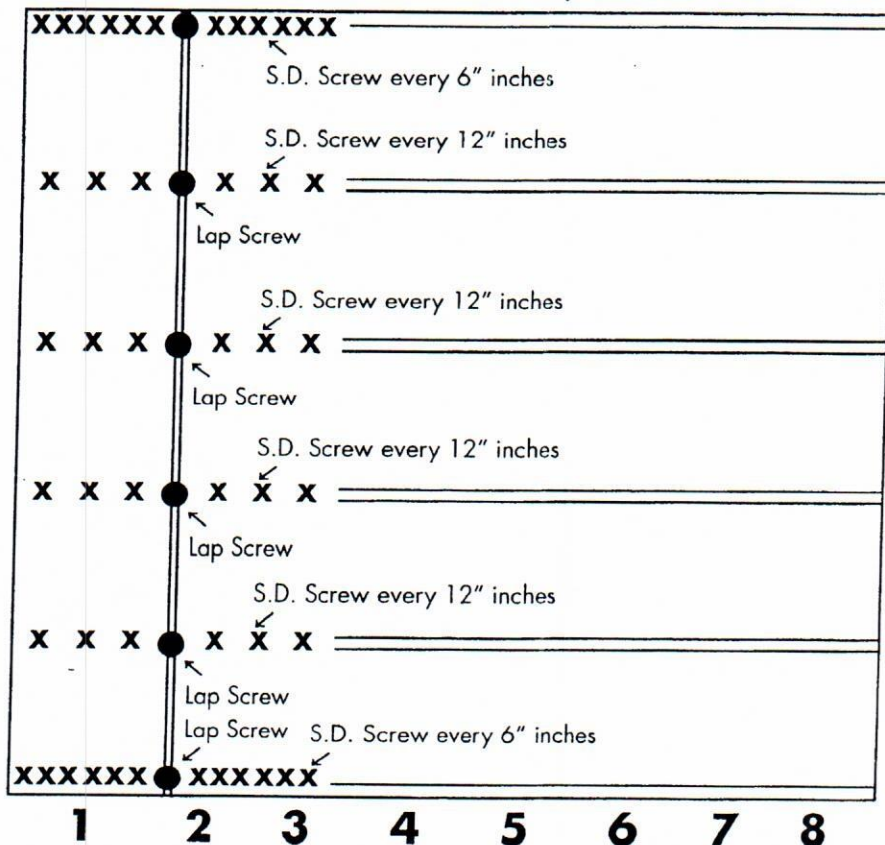

**NOTE:** This structure has no engineered specifications but has produced excellent results in numerous installations. Please check local building codes for compliance.